

- ① x1 plastic housing
- ② x1 overmolded seal

Panel cutting

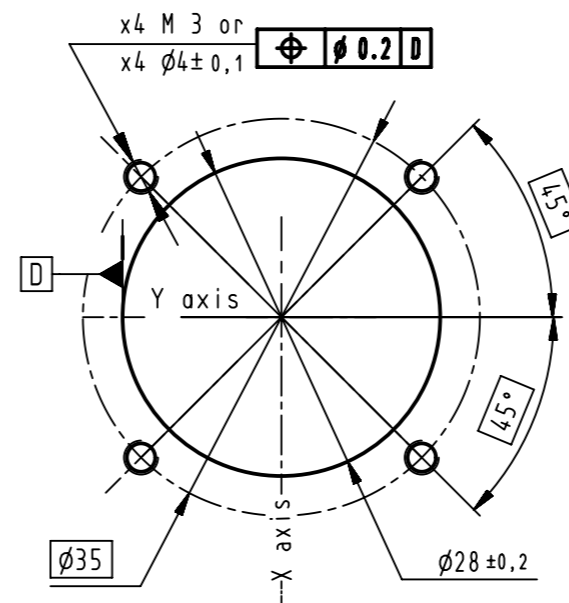

Connector pitch on panel = 35mm

Screwing by 4x M3 screws with torque 0.5N.m with flat washer under the screw

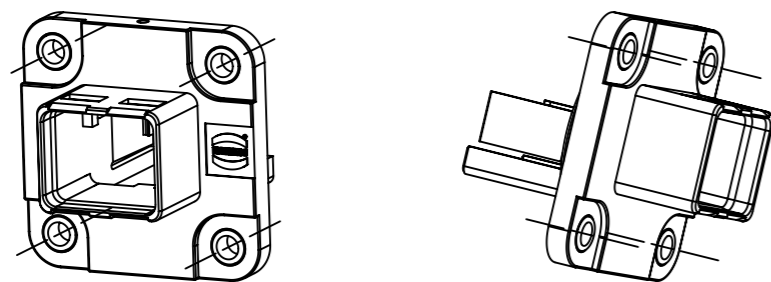

	All rights reserved	Created by	Inspected by	Standardisation	Date	State	
	Department EC PD - FR	BARLEMONT	DAUCHELLE	KOHLER	2013-08-05	Final Release	
HARTING Electronics GmbH D-32339 Espelkamp		Title HPP Easyinstall housing for HIFF insert				Doc-Key / ECM-Nr. 100191153/UGD/002/B 50000054806	
		Type	Number		Rev.	Page	
		TB	09455450032		B	1/1	